

### Overview

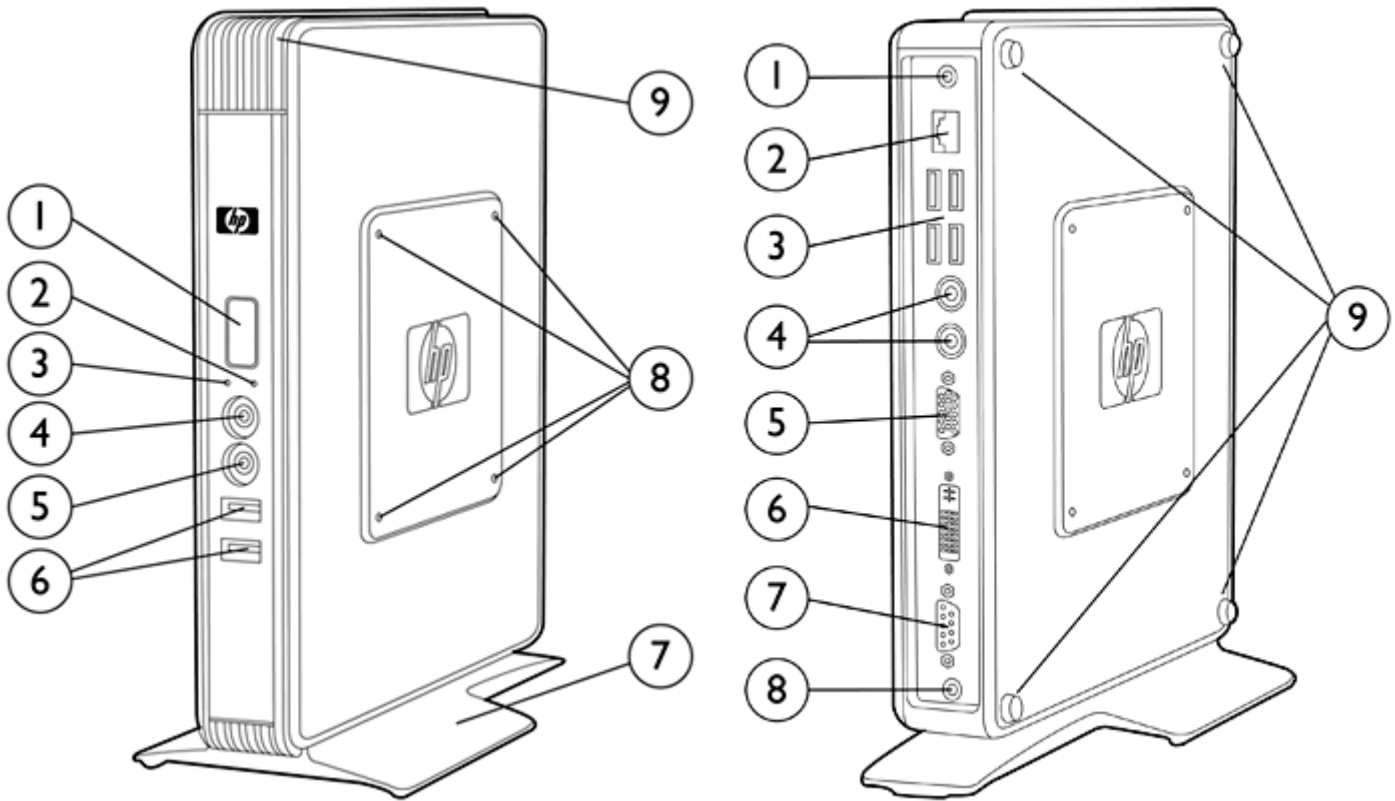

Front

Back

1. Power button
2. Power on indicator
3. Flash activity indicator
4. Audio connector (headphone/speaker out)
5. Audio connector (mic in)
6. USB connectors (two)
7. Removable stand for vertical orientation
8. Mounting points for HP Quick Release
9. Secure USB compartment

1. Audio out
2. Ethernet RJ-45 connector
3. USB connectors (four)
4. PS/2 connectors (two)
5. VGA monitor connector
6. DVI-D monitor connector
7. Serial connector
8. +12V DC power input
9. Feet for horizontal orientation (four)

### Overview

with optional t5730/t5735 Expansion Module Kit

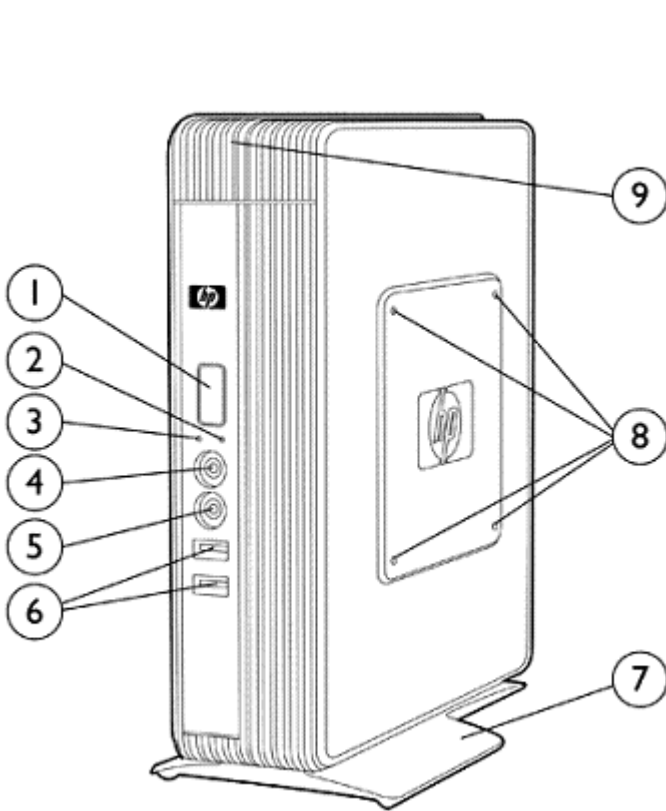

1. Power button
2. Power on indicator
3. Flash activity indicator
4. Audio connector (headphone/speaker out)
5. Audio connector (mic in)
6. USB connectors (two)
7. Removable stand for vertical orientation
8. Mounting points for HP Quick Release
9. Secure USB compartment

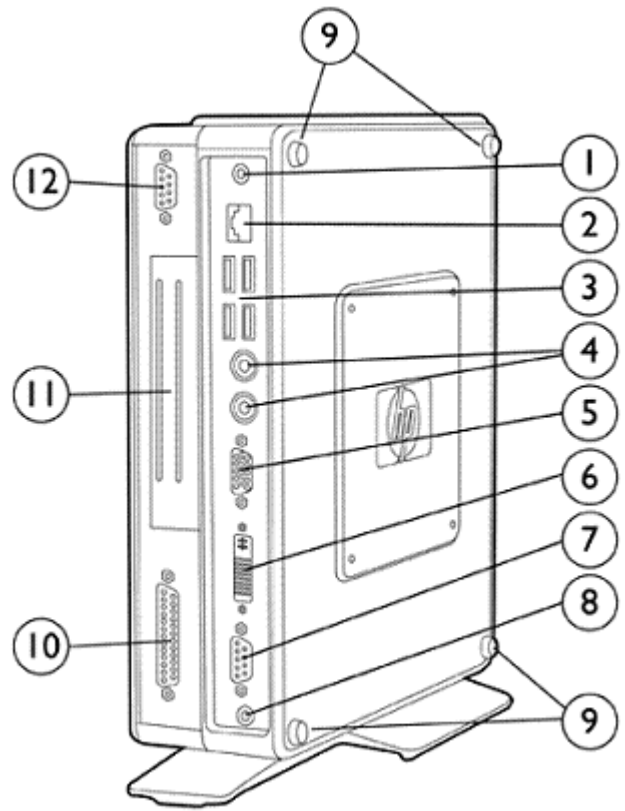

1. Audio out
2. Ethernet RJ-45 connector
3. USB connectors (four)
4. PS/2 connectors (two)
5. VGA monitor connector
6. DVI-D monitor connector
7. Serial connector
8. +12V DC power input
9. Feet for horizontal orientation (four)
10. Parallel connector
11. PCI/PCIe slot access
12. Second serial connector

## Overview

### At A Glance

- AMD Sempron 2100+ 1GHz processor for leading performance
- 1 GB flash memory provides ample storage for drivers and applications
- 512 MB system memory (32 MB reserved for graphics memory)
- Debian Linux OS with support for local applications including custom and open source applications
- Flexibility in choice of options and peripherals
- Includes GNOME desktop, Debian Iceweasel (Firefox) browser, Citrix ICA, rdesktop RDP client, HP ThinState, and full license for Altiris Deployment Solution
- Powerful ATI Radeon X1250 graphics supporting a broad range of HP monitors including widescreens and touch screens
- Built in dual monitor support (VGA and DVI-D native)
- Optional Expansion Module with PCI and PCI Express x1, for installing a wide range of devices (includes a parallel and second serial port)
- Secure USB compartment is ideal for protecting USB devices
- Legacy support includes parallel (via Expansion Module), serial, and PS/2 connections, along with eight USB 2.0 ports.
- Protected by Hewlett-Packard Services, including a limited three-year mail-in warranty (certain restrictions and exclusions apply)

### Standard Features

GY231AA#ABA (standard)	<b>Processor</b>	AMD Sempron 2100+, 1 GHz
	<b>Operating System</b>	Debian Linux 4.0 (Linux 2.6 kernel)
GY231AT#ABA (Top Value/Smart Buy)	<b>Flash Memory</b>	1 GB
	<b>Memory</b>	512 MB DDR-2 SODIMM <b>NOTE:</b> 32 MB reserved for graphics memory
GY368AA#ABA (TAA compliant) <sup>1</sup>	<b>Graphics</b>	ATI Radeon X1250 graphics
	<b>Browser</b>	Debian Iceweasel (Firefox)
	<b>Client Management Software</b>	Altiris Deployment Solution (full license) and HP ThinState included with each thin client.
	<b>Terminal Personalities</b>	Standard
	<b>Keyboard</b>	USB or PS/2 Type of included keyboard (USB or PS/2) varies by region.
	<b>Mouse</b>	USB or PS/2 Type of included mouse (USB or PS/2) varies by region.

<sup>1</sup> Product complies with U.S. Trade Agreement (TAA). Available in U.S. only.

### Options

		Part Number <sup>1</sup>
<b>Accessories</b>	HP t5730/t5735 Expansion Module	GZ286AA
	HP Quick Release Kit	EM870AA
	HP/Kensington Cable Lock	PC766A
	50 Watt External Power Supply	FJ851AA
<b>Communications</b>	Modem Serial – Zoom 3049 56K v.92 Ext. <sup>2</sup>	3049-00-00
<b>Input Devices</b>	HP PS/2 Standard Keyboard	DT527A
	HP USB Standard Keyboard	DT528A
	HP USB Smartcard Keyboard	ED707AA
	HP PS/2 2-Button Optical Mouse	EY703AA
	HP USB 2-Button Optical Scroll Mouse	DC172B
<b>Monitors<sup>3</sup></b>	ELO Touch 1529L Flat Panel – USB /serial combo <sup>2,4</sup>	E926109
	HP L5006tm LCD Touchscreen – USB/serial combo <sup>4</sup>	RB146AA
<b>Graphics</b>	Matrox EpicA TC4	EPI-TC4P128LPAF
	Matrox EpicA TC2	EPI-TC2P64LPAF
<b>Memory</b>	Apacer 1 GB Flash Module	AH430AA
<b>Security</b>	HP USB Smartcard Keyboard	ED707AA
	SCM USB Smart Card Reader SCR331 <sup>5</sup>	904054
	HP/Kensington Cable Lock	PC766A
<b>Storage</b>	Apacer 2 GB Disk on Key (DOK) <sup>5</sup>	AP-HHR2009D2G
	External USB 2.0 Multibay II Cradle	PA509A
	Multibay II DVD Drive (Does not support DVD play back)	PA849A

### Options

Care Packs <sup>6,7</sup>	9x5 Next-Business-Day Advanced Exchange – 3 Years	331653-001; U4847E
	9x5 Next-Business-Day On-Site Coverage – 3 Years	331655-001; U4849E
	Hardware Installation	331686-001; U4865E

<sup>1</sup>The warranties for HP or Compaq branded products are set forth in the express limited warranty statements accompanying such products. Although third-party products may work effectively on HP or Compaq thin clients, these non-HP or non-Compaq products are provided "AS IS." HP does not support or warrant third-party products, including the interoperability of such products with HP or Compaq thin clients. However, third-party manufacturers and vendors may provide their own warranties and support directly to you. Please contact the manufacturers or vendors for hardware or software support on their products.

<sup>2</sup>Option and support available directly from third party.

<sup>3</sup>For a complete list of monitors compatible with HP Compaq thin clients, it is important to cross-reference the supported video resolutions of the HP Compaq thin client to the supported resolutions of the monitor. Most HP monitors have one or more supported resolutions that match HP Compaq thin client products.

<sup>4</sup>Only serial is supported.

<sup>5</sup>Option and support is available directly from third party.

<sup>6</sup>Service levels and response times for HP Care Packs may vary depending on your geographic location. Restrictions and limitations apply. For details, visit [www.hp.com/go/carepack](http://www.hp.com/go/carepack).

<sup>7</sup>U4847E is available in all regions; U4849E is available in Americas and Asia-Pacific/Japan.

### Technical Specifications

<b>Processor</b>	AMD Sempron 2100+, 1 GHz
<b>Memory</b>	<b>Flash Memory</b> 1 GB <b>System Memory</b> 512 MB or 1 GB DDR-2 SODIMM <b>NOTE: 32 MB reserved for graphics memory</b>
<b>Graphics</b>	ATI Radeon X1250 graphics with support for high-resolution monitors up to 2048 x 1536, or up to 32 bit color depth <b>Mode</b> 800 x 600; 960 x 600 1024 x 768 1152 x 864 1280 x 720 ; 1280 x 768; 1280 x 800; 1280 x 1024 1360 x 768; 1366 x 768; 1368 x 768 1400 x 1050
<b>Input/Output/ Peripheral Support</b>	<b>Keyboard</b> USB or PS/2 Type of included keyboard (USB or PS/2) varies by region. <b>Mouse</b> USB or PS/2 (both supported) Mouse included with every thin client. Type of included mouse (USB or PS/2) varies by region. <b>Printer</b> Local and/or network printers (RDP, ICA, LPD) as per the printer support statement. <b>Video</b> ATI Radeon X1250 graphics
<b>Audio</b>	<b>Output</b> Internal amplified speaker, 1/8-inch mini, full 16-bit stereo, 44-kHz sample rate. <b>Input</b> 1/8-inch mini microphone
<b>Security</b>	One security lock slot (cable lock sold separately) Support for Smart Card options
<b>Terminal Server Protocols and Session Brokers</b>	Integrated Citrix ICA 10.x and rdesktop RDP 1.5 for remote terminal services Terminal personalities standard
<b>Networking</b>	10/100/1000 Gigabit Ethernet, twisted pair (RJ-45) TCP/IP with DNS and DHCP Point-to-Point Protocol (PPP), Direct Connection through RS-232, Wake on LAN (WOL), PXE
<b>I/O ports and connectors</b>	Eight USB 2.0 ports (two in front, four in rear, two in secure USB compartment), 1 VGA, 1 DVI-D, 2 PS/2, 1 serial, 1 RJ-45, and 1 optional Expansion Module with PCI or PCIe x1, including 1 parallel and second serial port
<b>Resident Operating System</b>	Debian Linux 4.0 with Kernel 2.6
<b>Server OS Compatibility/ Support</b>	Citrix Presentation Server (up to 4.5) Citrix Metaframe Presentation Server 3.0, Citrix Metaframe XP Presentation Server Citrix Metaframe 1.x Windows 2000/2003 Server families, Windows 2000/2003 Server Terminal Services Windows 2000 Advanced Server, Windows 2000 Advance Server Terminal Services Microsoft® Windows® NT 4.0 Server, Windows NT 4.0 Terminal Server Edition VMware Virtual Desktop Infrastructure using RDP
<b>Pre-Installed Software</b>	Debian Linux 4.0 with Kernel 2.6 Citrix ICA, rdesktop RDP client, and terminal emulation software Debian Iceweasel (Firefox) browser

### Technical Specifications

HP ThinState for rapid deployment  
 Altiris Deployment Solution (full client license). Altiris Deployment Solution (management console) available as free download from Altiris at: [www.altiris.com/hptc](http://www.altiris.com/hptc)  
 Other software available as add-ons (see [www.hp.com/support](http://www.hp.com/support) for latest list of available add-ons)

<b>OS Languages</b>	English	
<b>Dimensions H x W x D</b> (approximate)	<b>Without stand</b>	10.0 x 1.8 x 8.47 in (254.5 x 45.7 x 215.14 mm)
	<b>With stand</b>	10.5 x 1.8 x 8.47 in (266.7 x 45.7 x 215.14 mm)
	<b>With Expansion Module</b>	10.0 x 3.0 x 8.47 in (254.5 x 76.2 x 215.14 mm)
<b>Weight</b> (approximate)	<b>With stand</b>	3.5 lb (1.6 kg)
	<b>With Expansion Module</b>	4.8 lb (2.2 kg)
<b>Environmental</b>	<b>Temperature range on</b>	50° to 104° F (10 to 40° C)
	<b>- with optional Expansion Module or mounted with HP Quick Release</b>	50° to 95° F (10° to 40° C)
	<b>Temperature range off</b>	-22° to 140° F (-30 to 60° C)
	<b>Humidity</b>	20% to 80% condensing 10% to 90% non-condensing
<b>Regulatory Compliance</b>	<b>Power<sup>1</sup></b>	Worldwide auto-sensing 100-240 VAC, 50-60 Hz, energy-saving automatic power-down, surge-tolerant, Energy Star compliant 50-watt power supply.
	<b>Ergonomics</b>	German ZH1/618; EN29241-3, approved
	<b>Safety</b>	UL 1950, CSA 950; TÜV-GS (EN60 950) approved
	<b>RF Interference</b>	FCC Class B; CE Mark; EN55022B; VCCI
<b>Warranty</b>	Three-year limited hardware warranty.	

**NOTE:** Certain restrictions apply. Consult the HP Customer Support Center for details.

<sup>1</sup>The actual power consumption at your location could vary and is dependent on many factors including but not limited to software load on the thin client, attached peripherals, and environmental factors.

Emulations	Emulation	Terminal ID
	ADDS A2	
	AIXTerm	
	ANSI BBS	
	AT 386	
	DG 410	
	HP 70092	70092
	HZ1500	
	IBM3151	Mod11, Mod31
	IBM3270	3278-2 (24x80), 3278-3 (32x80), 3278-4 (43x80), 3278-5 (27x132), 3278-2-E (24x80), 3278-E (32x80), 3278-4-E (43x80), 3278-5-E (27x132), 3279-2 (24x80), 3279-3 (32x80), 3279-4 (43x80), 3279-5 (27x132), 3287-1
	IBM5250	5291-1, 5292-2, 5251-11, 3179-2, 3196-A1, 3180-2, 3477-FC (27x132), 3477-FG (24x80), 3486-BA, 3487-HA, 3487-HC, 3812-1
	SCO Console	
	TA6530	
	TVI910	

### Technical Specifications

TVI920	
TVI925	
TVI950	
TVI955	
VT52, VT100	VT100, VT101, VT102, VT125, VT131, VT132, M2200, VT220, VT240, VT320, VT340, VT420
VT HP220	VT-HP220
WY50	
WY50+	
WY60	

### Environment-friendly Products and Approach

#### RoHS Compliance

Hewlett-Packard is committed to compliance with all applicable environmental laws and regulations, including the European Union Restriction of Hazardous Substances (RoHS) Directive. HP's goal is to exceed compliance obligations by meeting the requirements of the RoHS Directive on a worldwide basis. From July 1, 2006, RoHS substances will be virtually eliminated (virtually = to levels below legal limits) for all HP electronic products subject to the RoHS Directive, except where it is widely recognized that there is no technically feasible alternative (as indicated by an exemption under the EU RoHS Directive).

#### Material Usage

This product does not contain any of the following substances in excess of regulatory limits (refer to the HP General Specification for the Environment at: [http://www.hp.com/hpinfo/globalcitizenship/environment/supplychain/gen\\_specifications.html](http://www.hp.com/hpinfo/globalcitizenship/environment/supplychain/gen_specifications.html)):

- Asbestos
- Certain Azo Colorants
- Certain Brominated Flame Retardants – may not be used as flame retardants in plastics
- Cadmium
- Chlorinated Hydrocarbons
- Chlorinated Paraffins
- Formaldehyde
- Halogenated Diphenyl Methanes
- Lead carbonates and sulfates
- Lead and Lead compounds
- Mercuric Oxide Batteries
- Nickel – finishes must not be used on the external surface designed to be frequently handled or carried by the user.
- Ozone Depleting Substances
- Polybrominated Biphenyls (PBBs)
- Polybrominated Biphenyl Ethers (PBBEs)
- Polybrominated Biphenyl Oxides (PBBOs)
- Polychlorinated Biphenyl (PCB)
- Polychlorinated Terphenyls (PCT)
- Polyvinyl Chloride (PVC) – except for wires and cables, and certain retail packaging has been voluntarily removed from most applications.
- Radioactive Substances
- Tributyl Tin (TBT), Triphenyl Tin (TPT), Tributyl Tin Oxide (TBTO)

#### Packaging

HP follows these guidelines to decrease the environmental impact of product packaging:

### Technical Specifications

- Eliminate the use of heavy metals such as lead, chromium, mercury and cadmium in packaging materials.
- Eliminate the use of ozone-depleting substances (ODS) in packaging materials.
- Design packaging materials for ease of disassembly.
- Maximize the use of post-consumer recycled content materials in packaging materials.
- Use readily recyclable packaging materials such as paper and corrugated materials.
- Reduce size and weight of packages to improve transportation fuel efficiency.
- Plastic packaging materials are marked according to ISO 11469 and DIN 6120 standards.

#### End-of-life Management and Recycling

Hewlett-Packard offers end-of-life HP product return and recycling programs in many geographic areas.

To recycle your product, please go to: <http://www.hp.com/recycle> or contact your nearest HP sales office. Products returned to HP will be recycled, recovered or disposed of in a responsible manner.

The EU WEEE directive (2002/95/EC) requires manufacturers to provide treatment information for each product type for use by treatment facilities. This information (product disassembly instructions) is posted on the Hewlett Packard web site at: <http://www.hp.com/go/recyclers>.

These instructions may be used by recyclers and other WEEE treatment facilities as well as HP OEM customers who integrate and re-sell HP equipment.

#### Hewlett-Packard Corporate Environmental Information

For more information about HP's commitment to the environment: [link to new HP white paper now in progress]

Global Citizenship Report:

<http://www.hp.com/hpinfo/globalcitizenship/gcreport/index.html>

Eco-label certifications:

<http://www.hp.com/hpinfo/globalcitizenship/environment/productdesign/ecolabels.html>

ISO 14001 certificates:

<http://www.hp.com/hpinfo/globalcitizenship/environment/operations/envmanagement.html>

---

© 2008 Hewlett-Packard Development Company, L.P.

Microsoft, Windows, and Windows NT are trademarks or registered trademarks of Microsoft Corporation in the United States and other countries. AMD and Geode are trademarks of Advanced Micro Devices, Inc.

The information contained herein is subject to change without notice and is provided "as is" without warranty of any kind. The warranties for HP products and services are set forth in the express limited warranty statements accompanying such products and services. Nothing herein should be construed as constituting an additional warranty. HP shall not be liable for technical or editorial errors or omissions contained herein.